

1. Unscrew the mounting plate.

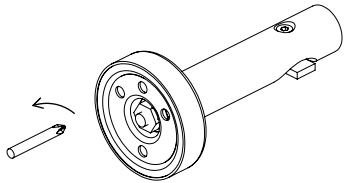

2. Mark the location of the holes on the wall.

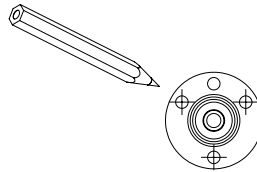

3. Predrilling 6mm.

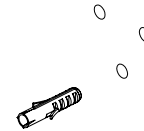

4. Screw on the mounting plate firmly.

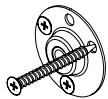

5. Unscrew the decorative cap from the bracket (a) and screw it onto the mounting plate (b).

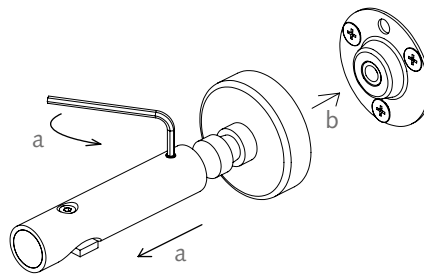

6. Loosen the screw so that the plate (c) comes loose.

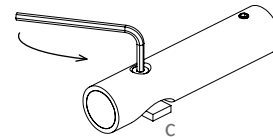

7. Insert the plates of the wall bracket into the rail (a) while the rail is still on the floor. Attach all wall brackets to the plates on the rail (b). Tighten the screw so that you can position the wall brackets.
8. Place the rail on the wall.

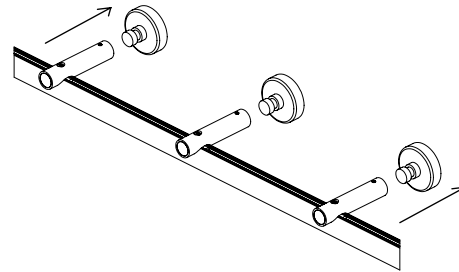
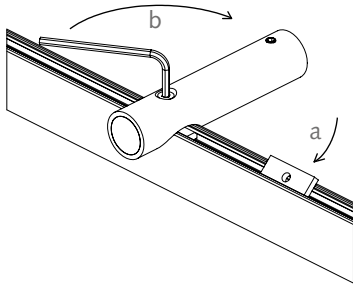

9. Tighten the screw for the decorative cap firmly.

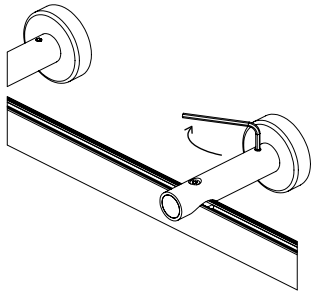

10. Slide the rail in the desired position and tighten all screws firmly.

