



ONE-WAY DRAW  
CURTAINS



CENTER DRAW  
CURTAINS

## FOREST FMS ADJUSTABLE WAVE SET Instructions

Scan for the instructionvideo



THE WORLD  
BEHIND  
YOUR  
CURTAINS

ONE-WAY DRAW CURTAINS

CENTER DRAW CURTAINS

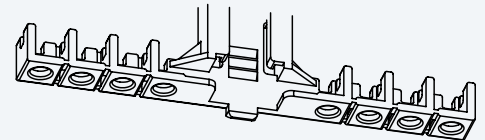
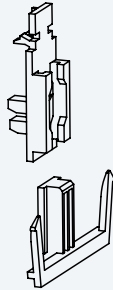
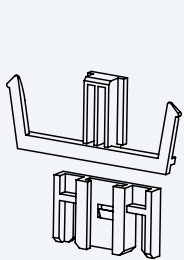

**WAVE ADJUSTABLE HOOK FOR SHUTTLE MOTOR**  
for one-way draw and center draw curtains

**WAVE ADJUSTABLE HOOK RETURN PULLEY**  
for center draw curtains

**WAVE ADJUSTABLE MASTER CARRIER UNDERLAP**  
for one-way draw curtains and center draw curtains

**Position:**

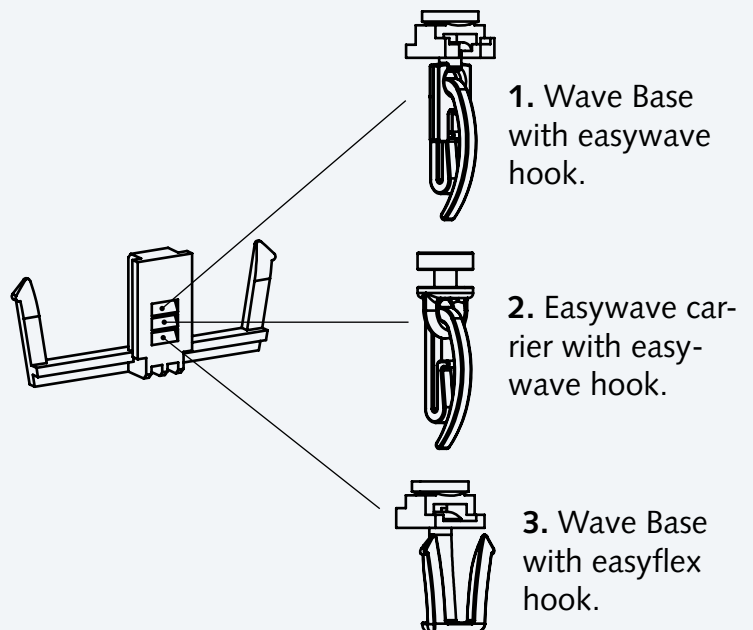
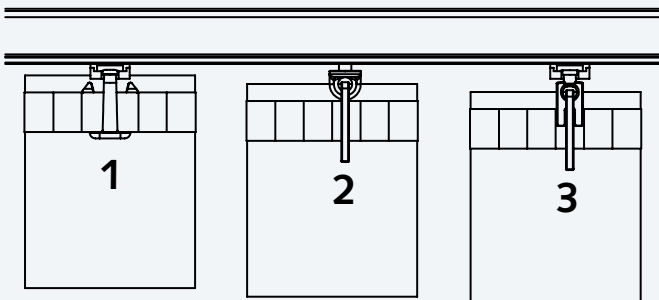

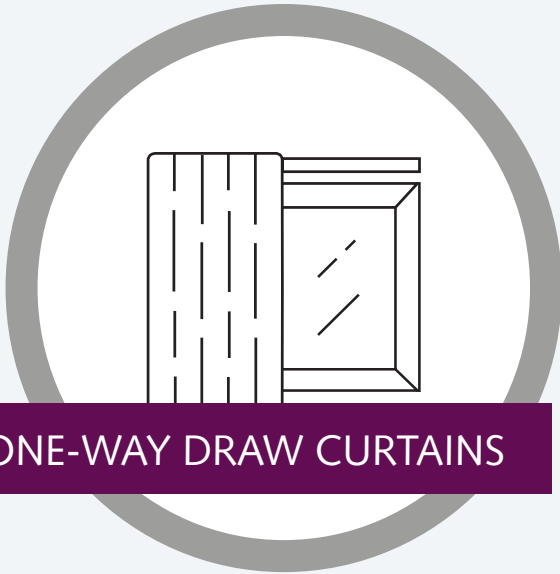

ONE-WAY DRAW CURTAINS

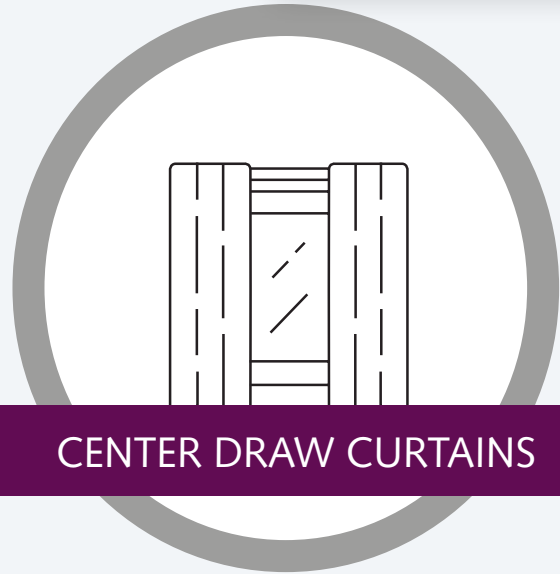

CENTER DRAW CURTAINS



ATTACH THE FMS WAVE ARM

TO THE FMS MASTER CARRIER

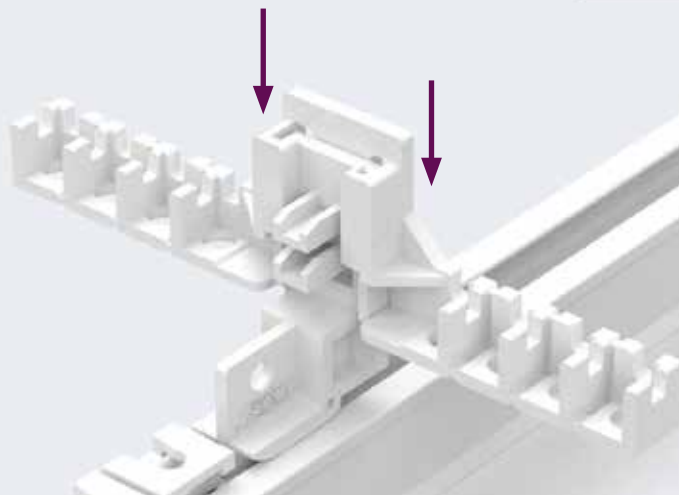

CHOOSE THE REQUIRED HEIGHT SETTING

BY CHOOSING ON OF THE THREE POSITIONS (YOU CAN HEAR THE CLICK)

- 1
- 2
- 3

SQUEEZE AND  
CHOOSE POSITION

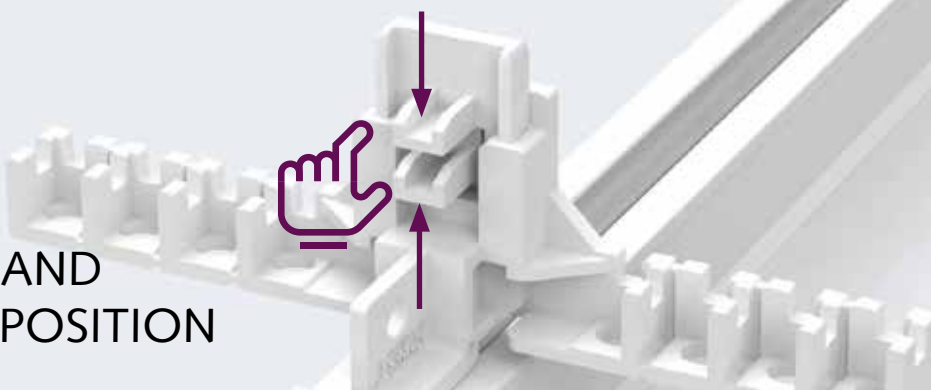

**CHOOSE THE REQUIRED WIDTH SETTING**

BY MAKING A SMALL CUT INTO THE CUBE OF THE FMS WAVE ARM AND BREAKING IT OFF

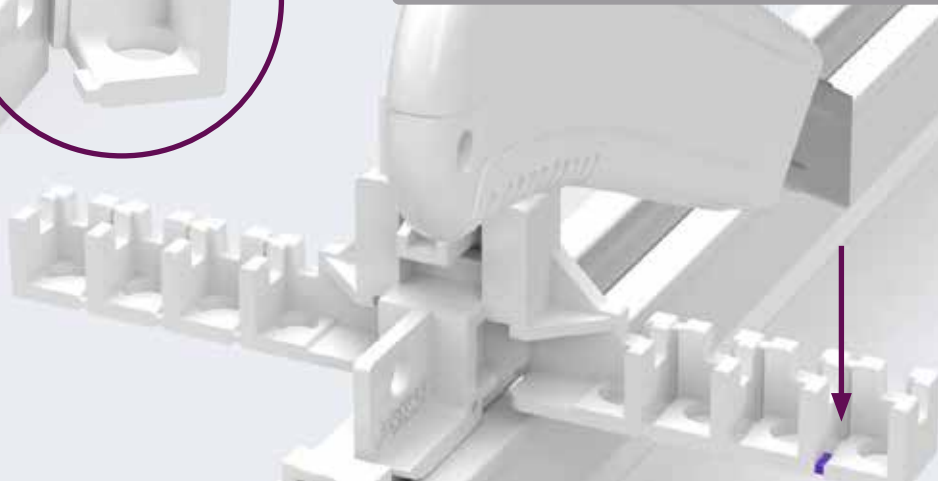
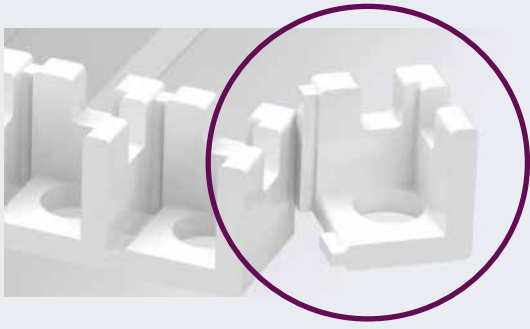

OR USE A PLIER

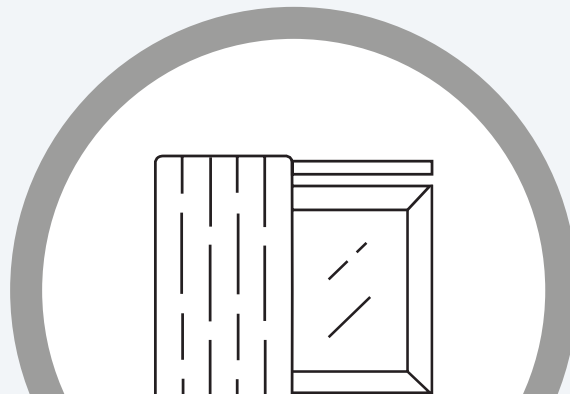

ONE-WAY DRAW

CONTINUE

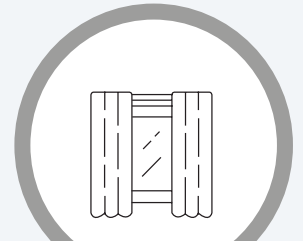

CENTER DRAW CURTAINS

GO TO PAGE 6

**ATTACH THE MOTOR**

TO THE FMS MOTOR PULLEY AND SECURE THE LOCKING PIN

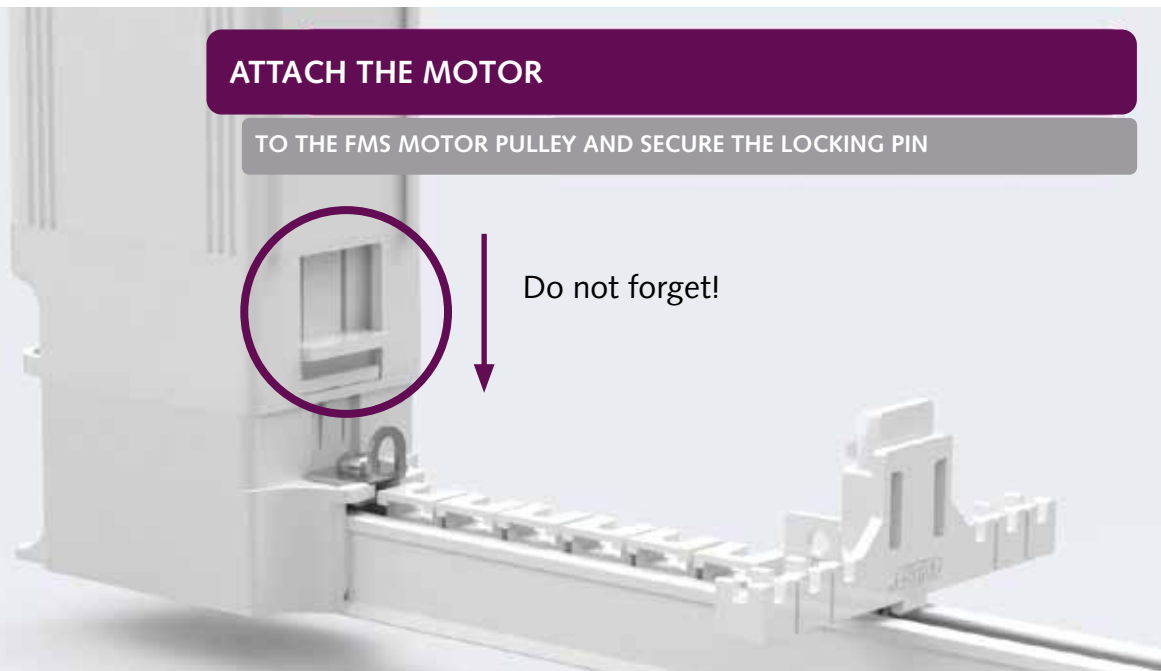

"TURN THE FOREST SHUTTLE MOTOR IN NORMAL POSITION"

TAKE THE END HOOK AND CHOOSE

THE REQUIRED HEIGHT SETTING (YOU CAN HEAR THE CLICKS)

1  
2  
3 ▼



FINISH THE ASSEMBLY BY ATTACHING

THE END HOOK TO THE FMS MOTOR PULLEY



"THE ONE WAY DRAW CURTAIN ASSEMBLY IS NOW READY!"

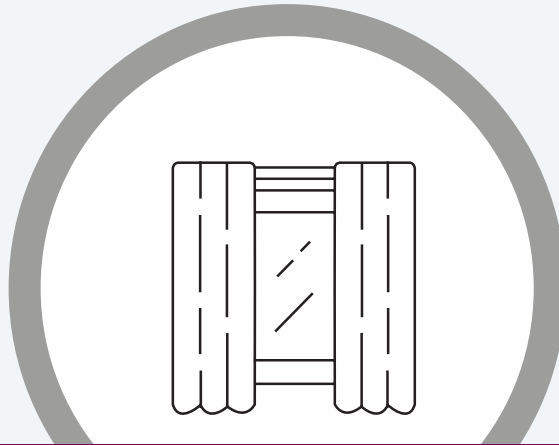

CENTER DRAW

LOOSEN THE LOCK SCREW AND SLIDE IT

WITH THE CARRIERS INTO THE TRACK

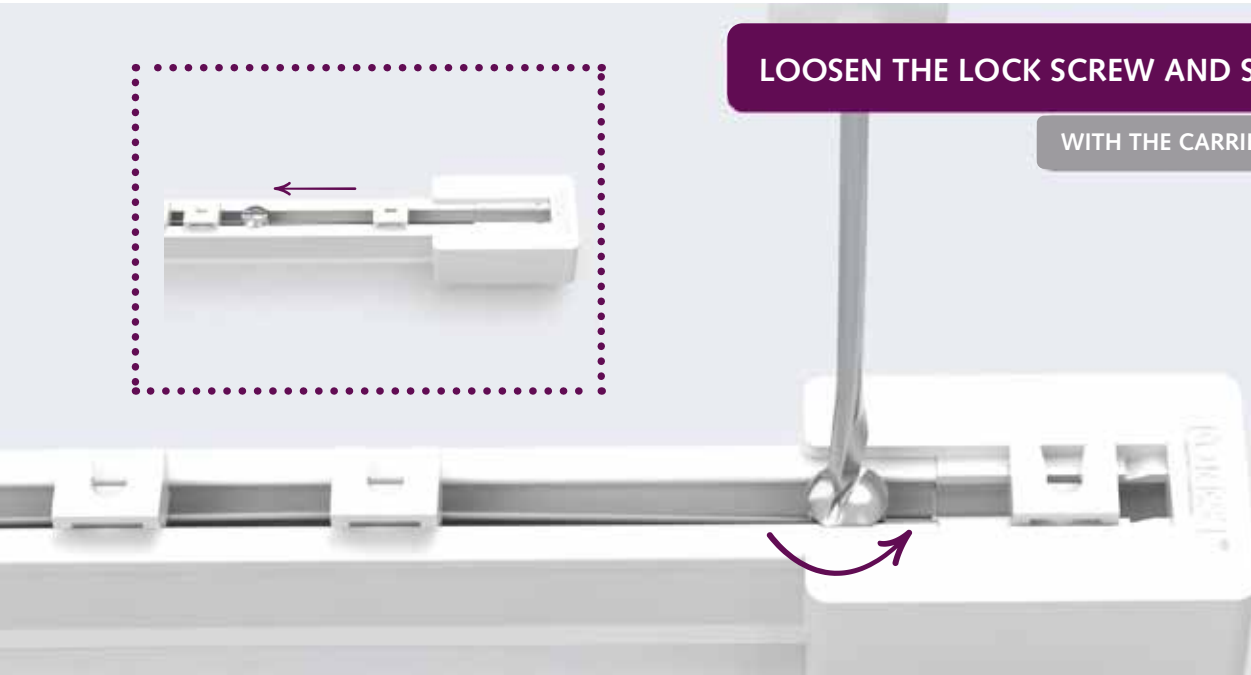
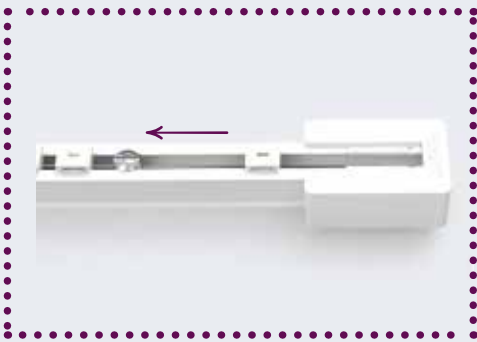

1

2 Then rotate

ATTACH THE END HOOK TO THE TRACK (1)

ROTATE IT (2) AND SLIDE IT (3) INTO THE FMS RETURN PULLEY (4)



3

4

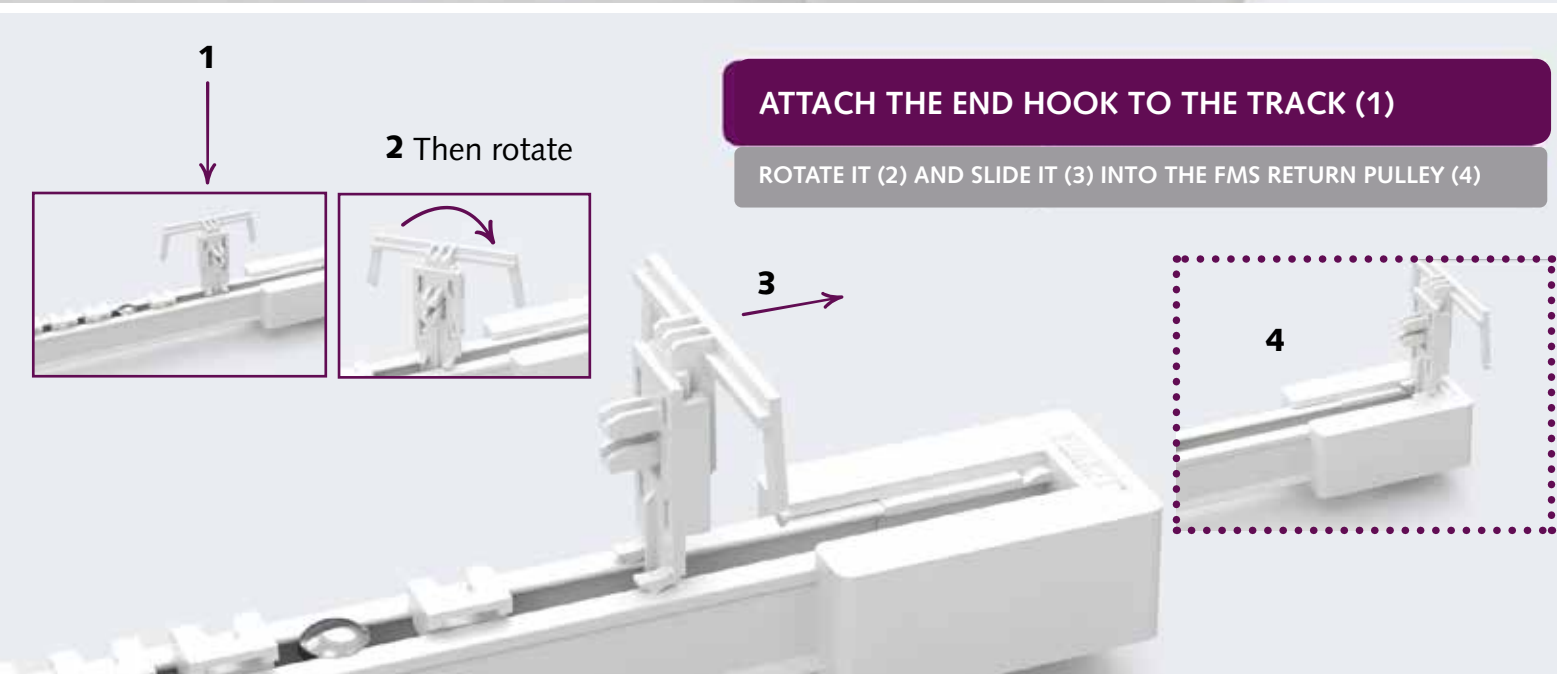

**PUT THE CARRIER AND LOCK SCREW**

INTO THE FMS RETURN PULLEY AND TIGHTEN THE SCREW

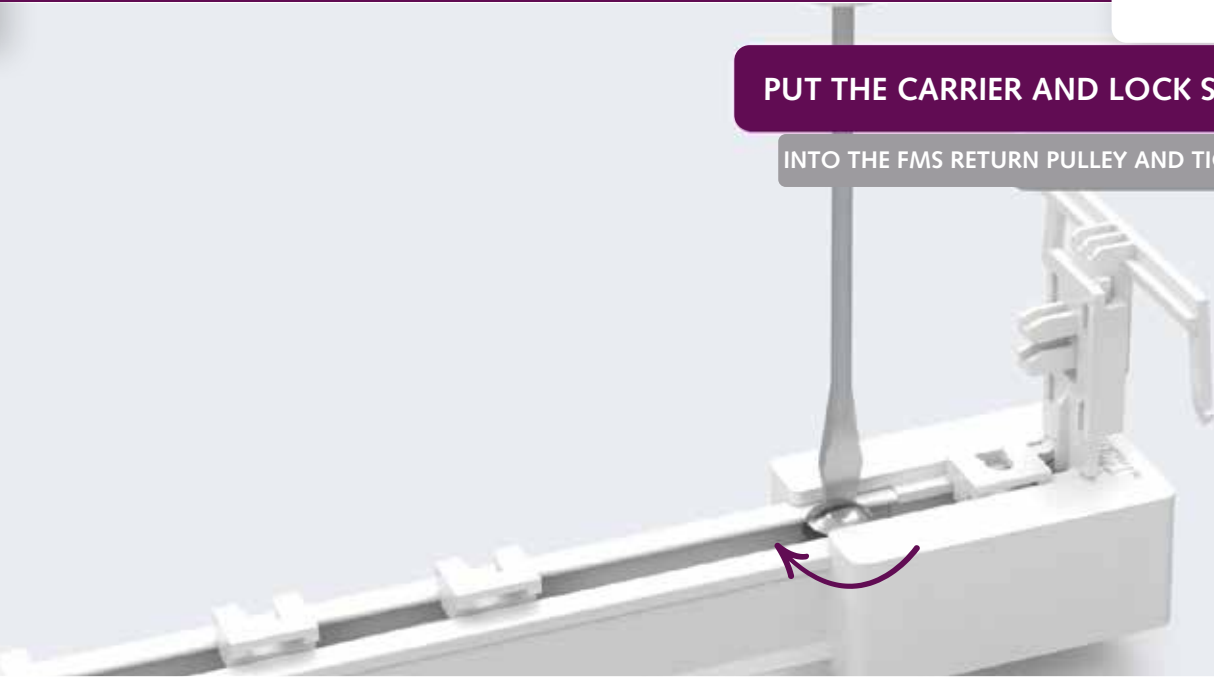

**CHOOSE THE REQUIRED HEIGHT SETTING**

BY CHOOSING ONE OF THE THREE POSITIONS (YOU CAN HEAR THE CLICKS)

- 1
- 2
- 3**

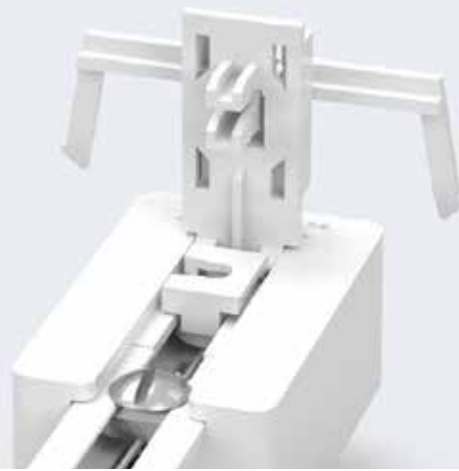

**ATTACH THE MOTOR TO THE FMS MOTOR PULLEY**

AND SECURE THE LOCKING PIN

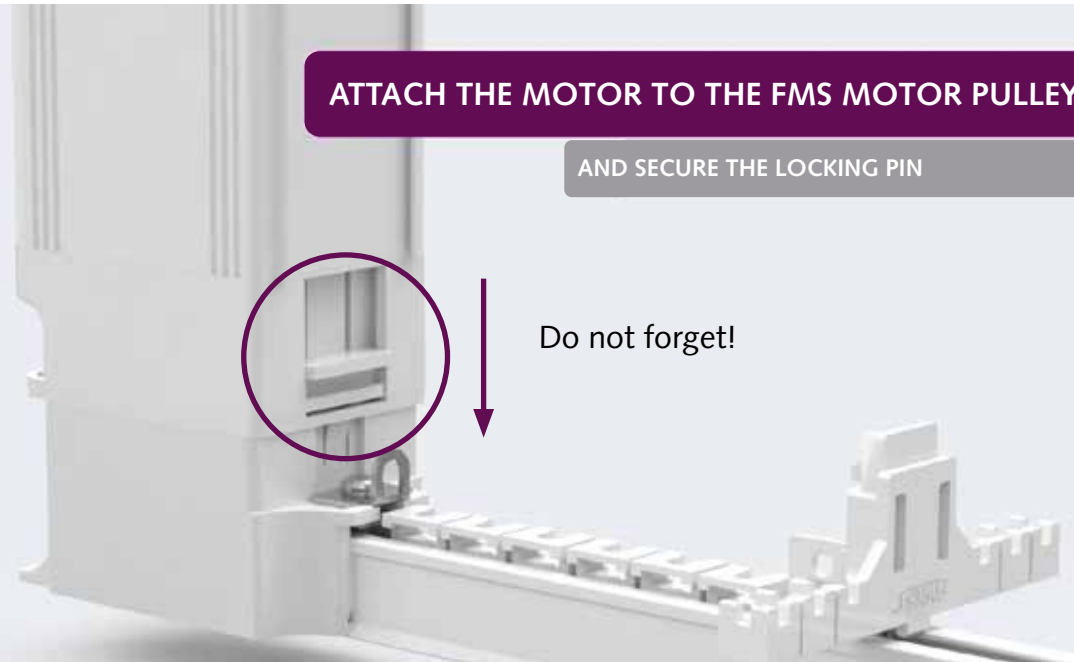

Do not forget!

“TURN THE FOREST SHUTTLE MOTOR IN NORMAL POSITION”

TAKE THE SECOND END HOOK

AND CHOOSE THE REQUIRED HEIGHT SETTING

1  
2  
3



FINISH THE ASSEMBLY BY ATTACHING

THE END HOOK TO THE FMS MOTOR PULLEY

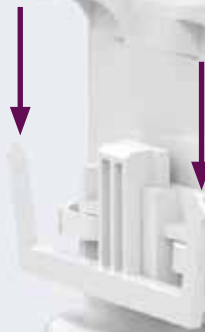

“THE CENTER DRAW CURTAIN ASSEMBLY IS NOW READY”



[WWW.FORESTGROUP.COM](http://WWW.FORESTGROUP.COM)