

# ASSEMBLY INSTRUCTIONS DS-XL LED STRIP



## STEP 1

Cut the LED strip to the desired length.



## STEP 2

Each 5cm there is a scissor sign.

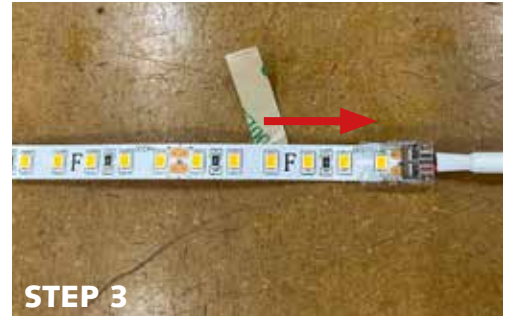

## STEP 3

Carefully slide the LED strip into the strip into the connector as shown above.



## STEP 4

Press the metal contacts into the connector.



Before

After



## STEP 5

With a rotary tool (e.g.) Dremel carve a bit of the motor pulley



## STEP 6

Now you have created a full opening.



## STEP 7

Now guide the cable through the carved slot.



## STEP 8

Put a small drop of instant glue on the back of the connector.



**STEP 9**

Put the connector into the track and press the connector until the glue hardens. Take off the foil of the back of the LED strip and press the sticky strip into the track



**STEP 10**

Slide the metal clip into the track

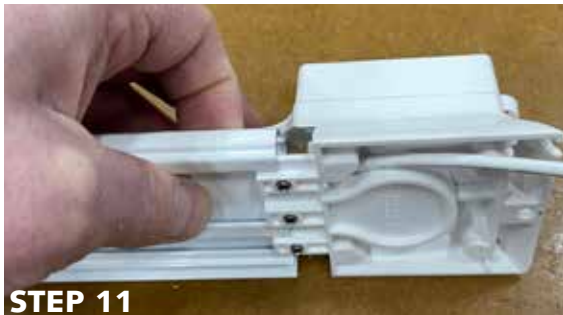

**STEP 11**

Carefully slide the motor pulley into the track, whilst keeping the connector in place with your finger.



**STEP 12**

Fix the motor pulley onto the track by tightening the three allen screws (not too tight).



**STEP 13**

Slide the metal clip in place and tighten the screw.



**STEP 14**

Put a small drop of instant glue on the back of the connector.