

ORDER FORM BS ROMAN BLIND

FOREST DRAPERY HARDWARE UK LIMITED, UNITED KINGDOM, FEB. 2025

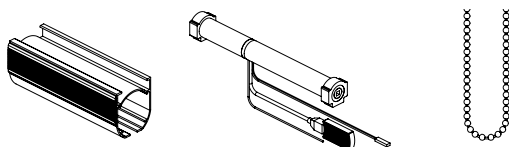

Company name:
Name:
Account number:
Your reference/commission:
Order date:

Colour: White
Length: cm (min. 38cm (chain) / 53cm (motor) and max. 5,80mtr) (including endcaps)
Quantity: piece(s)

Mode of operation: Chain Motorised
If motorised: Battery pack with accessories
Adaptor

FIXATION: BS ceiling bracket BS Smart Klick bracket wall/ceiling BS wall bracket swivel

Number of cord rolls:

Track length (in cm):	Number of cord rolls:
38-69	2
70-134	3
135-189	4
190-239	5
240-314	6

Track length (in cm):	Number of cord rolls:
315-364	7
365-399	8
400-464	9
465-489	10
490-580	11

Cord colour: White (standard) Brown Mocha Salmon
Corn Black Beige Eggplant
Grey Steel Terra Green
Off-white Old pink Moss Pink

Type of rod: 4mm Fiber white 4mm PVC transparent 6mm Alu grey 8mm Alu grey
Width rod: cm (standard **6 pieces** per system)
Type of counter weight: White 3x25mm White 3x40mm White 5x25mm White 6x20mm
Width counter weight: cm
Snap cord fixer: Standard Child Safety (extra costs)

Control (if motorised): Forest EasyTouch remote control, 6 channel RF
programmed channel: 1 2 3 4 5 6
Transparent EasyTouch wall holder (optional): piece(s)
White + quantity Black + quantity

Control (if chain): Control-unit: 1:4 (standard) 1:1
1:4 Child safety 1:1 Child safety
Control: Left Right
Chain drop height (from ceiling): 100 cm 200 cm
125 cm 250 cm
150 cm (standard) 300 cm
175 cm
Distance 'pitch' chain: 6 mm (standard) 12 mm
Colour chain: Metal Inox Black White (plastic, suitable for child safety control units)

Tension / Weight Design chain weight White Grey Black
Tension pulley
Wall mount safety box chain/cord (extra costs)

ORDER FORM BS ROMAN BLIND

FOREST DRAPERY HARDWARE UK LIMITED, UNITED KINGDOM, FEB. 2025

FOREST[®]
DRAPERY HARDWARE

Requests:

Expected production time: after date of receiving order, 10 working days. If quantity > 20 pieces, by negotiation.

Send the completed form to info@forestgroup.co.uk
We can only accept order forms that are completely filled out.
For help, please contact us at +44 (0)1706 522 088 or info@forestgroup.co.uk
You are responsible for providing complete and correct information on the order form.

Our latest order forms are online. Scan or click on the QR code for the latest order form.